



WREST POINT
Come Play.

WREST POINT HOTEL & CONFERENCE CENTRE

Your Tasmanian epicentre for remarkable
Conferences and Events



Nestled on the banks of the River Derwent and just five minutes from Hobart's city centre, Wrest Point Hotel and Conference Centre is the ultimate destination for your event. From large conferences to an elegant gala, a plenary session in our purpose-built auditorium or an intimate business meeting, all needs are catered for with newly renovated accommodation, event spaces, restaurants, bars, and ample free parking all conveniently located under one roof. Our dedicated and experienced team work with you to turn your dream event into a reality, with tailored options available for events of any size.

Conference facilities

- Range of small and large conference venues
- Gala and cocktail spaces
- Green room facilities
- State-of-the-art AV equipment and on-site technician
- Free guest Wi-Fi
- Catering
- Private bar available upon request

Accommodation

- 271 accommodation rooms in total
- 196 rooms in Wrest Point Tower with mountain or harbour view
- 42 rooms in Wrest Point Water Edge
- 33 rooms in Wrest Point Motor Inn
- Complimentary Wi-Fi
- Room service
- Mini bar

Dining

- **The Point Revolving Restaurant** – Premium restaurant with a French-inspired menu and a 360° view from the top of the tallest building in Tasmania.
- **Longhorn Smokehouse** – Serving up the best of American-style BBQ with locally-sourced ingredients. From smoked meats to grilled steaks and iconic side dishes.
- **Boardwalk Bistro & Café** – Crowd favourite with a focus on great value.
- **Kwan Ho** – Premium Chinese cuisines with views across the River Derwent.

Bars

- **The Birdcage Bar** – The cheekiest bar in Hobart. Enjoy signature cocktails, tasty bites and live entertainment.
- **Casino Bar** – Soak up the atmosphere of the casino with views across the River Derwent.
- **Boardwalk Bar** – Catch all the live sports action on big screens with cold drinks and good times.
- **The Green Room Bar** – The perfect place for post-event drinks, located in Wrest Point's Conference Centre.

Guest Services

- Common Area High-Speed WiFi
- Undercover & free onsite parking
- Electric car charging stations
- Concierge Services
- Laundry/Dry Cleaning Service
- Room service
- Wheelchair Access
- Recreation Facilities
- Gym
- Indoor swimming pool and sauna
- Mini-golf



Wrest Point has over 50 years of experience in planning and delivering exceptional events.

Location

Wrest Point enjoys Tasmania's perfect location – right on the edge of the harbour, only a short distance to the CBD, with spectacular views of the city, river and mountain.







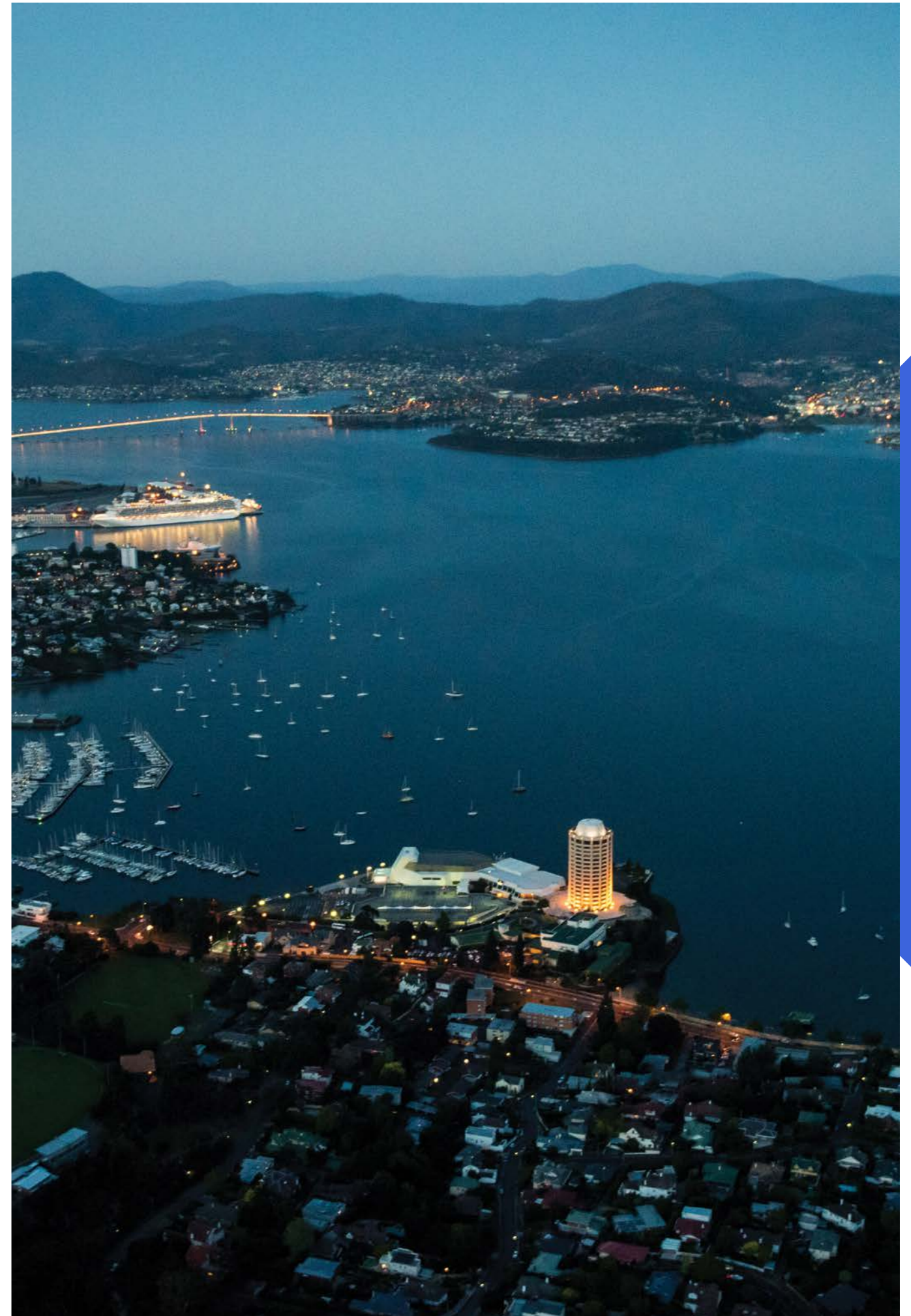



Transportation

FROM	DISTANCE	TIME
Airport	24km	approx 25 mins
CBD	3km	4 mins





Meeting Room Capacities

Room	Floor Area	Theatre style 	Rounds 	Long Tables 	Cocktail 	U Shape 	Classroom 	Boardroom 	Cabaret 	Trade Booths 
Tasman	691m ²	1000	540	588	800	120	300		320	41
Tasman A	253m ²	270	150	240	300	50	120	40	136	
Tasman B	111m ²	90	50	88	75	30	35	25	40	
Tasman C	112m ²	70	40	64	40	20	25	20	32	
Plenary Hall	648m ²	651	70	100			600			4
Tasman & Plenary Hall		1651	610	688	1000		900		376	45
Exhibition Foyer	620m ²	150	180	180	400					20
Boardwalk Gallery	520m ²	170	200	250	260	40	70	40	136	32
Wellington	310m ²	200	150	180	200	40	100	40	120	17
Wellington 1	160m ²	100	50	90	100	30	50	30	40	
Wellington 2	150m ²	100	50	90	100	30	50	30	40	
Drysdale Room	70m ²	50	50	50	50	20	35	25	40	
Executive Boardroom	39m ²							14		
Riviera Room	60m ²	40			40	20	25	25		
Derwent	540m ²	280	240	300	300		120		160	
Derwent 1	243m ²	170	110	140	150	40	75	35	88	
Derwent 2	115m ²	40	30	40	50	20	20	25	24	
Derwent 3	136m ²	50	40	50	75	20	25	25	24	
Showroom	447m ²	346		230	200	20	100	25	152	
Waterfront Lawn					5000					

Please note: These numbers are only a guide. Dance Floor, Buffet tables and AV requirements may alter seating capacity.

Come Play.

Restaurants/Cafés

- 1 The Point Revolving Restaurant
- 2 Longhorn Smokehouse
- 3 Kwan Ho
- 4 The Boardwalk Bistro & Cafe

Bars

- 1 Birdcage Bar & Lounge
- 2 The Green Room Bar
- 3 Boardwalk Bar
- 4 Casino Bar

Gaming

- 1 Casino & Gaming
- 2 Boardwalk Gaming
- 3 Club Forté Lounge

Accommodation

- 1 Tower
- 2 Motor Inn
- 3 Water Edge

Photo Opportunity

- 1 Fountain
- 2 Lawns
- 3 Boardwalk

Function Rooms

- 1 The Showroom
- 2 Tasman Room
- 3 Plenary Hall
- 4 Derwent Room
- 5 Boardwalk Gallery
- 6 Portlight Bar
- 7 Wellington Room
- 8 Riviera Room
- 9 Exhibition Foyer
- 10 Wellington Foyer
- 11 Drysdale Room
- 12 Executive Boardroom
- 13 Wellington Entrance

Points of Interest

- 1 Kitchen Garden
- 2 Boardwalk
- 3 Mini Golf
- 4 Walkway Trail
- 5 Duck Crossing
- 6 Duck Feeding

Facilities Key

- Reception & Guest Services
- Lift 1, Lift 2, Lift 3, Lift 4
- Car Park
- Toilets
- Information
- Smoking Area
- Taxi Stand
- Health Club
- Bus Stop
- ATM Machine
- Laundry





TASMAN ROOM

Tasmania's premier multi-purpose auditorium has played host to many of the state's most prestigious and memorable events. Featuring a full theatre-style main stage, it comfortably accommodates gala balls, symphonies, business conferences, concerts, shows, dinners, exhibitions, meetings, and functions. For larger events, the Tasman Room can be opened to the Plenary Hall, delivering theatre-style seating for up to 1650 guests.

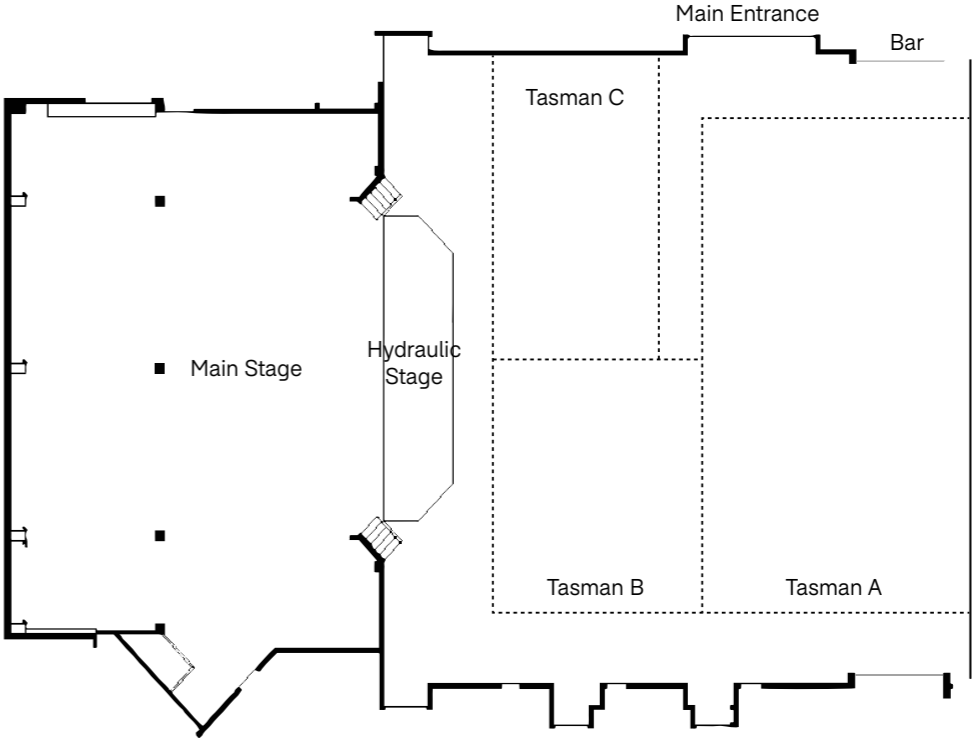

Room	Floor Area	Icon 1	Icon 2	Icon 3	Icon 4	Icon 5	Icon 6	Icon 7	Icon 8	Icon 9
Tasman	691m ²	1000	540	588	800	120	300		320	41
Tasman A	253m ²	270	150	240	300	50	120	40	136	
Tasman B	111m ²	90	50	88	75	30	35	25	40	
Tasman C	112m ²	70	40	64	40	20	25	20	32	



PLENARY HALL

The purpose-built Plenary Hall is one of Australia's finest conference auditoriums, suitable for keynote speakers, break-out groups, lectures, exhibitions, and presentations. This adaptable space can be opened to the Tasman Room for larger events.

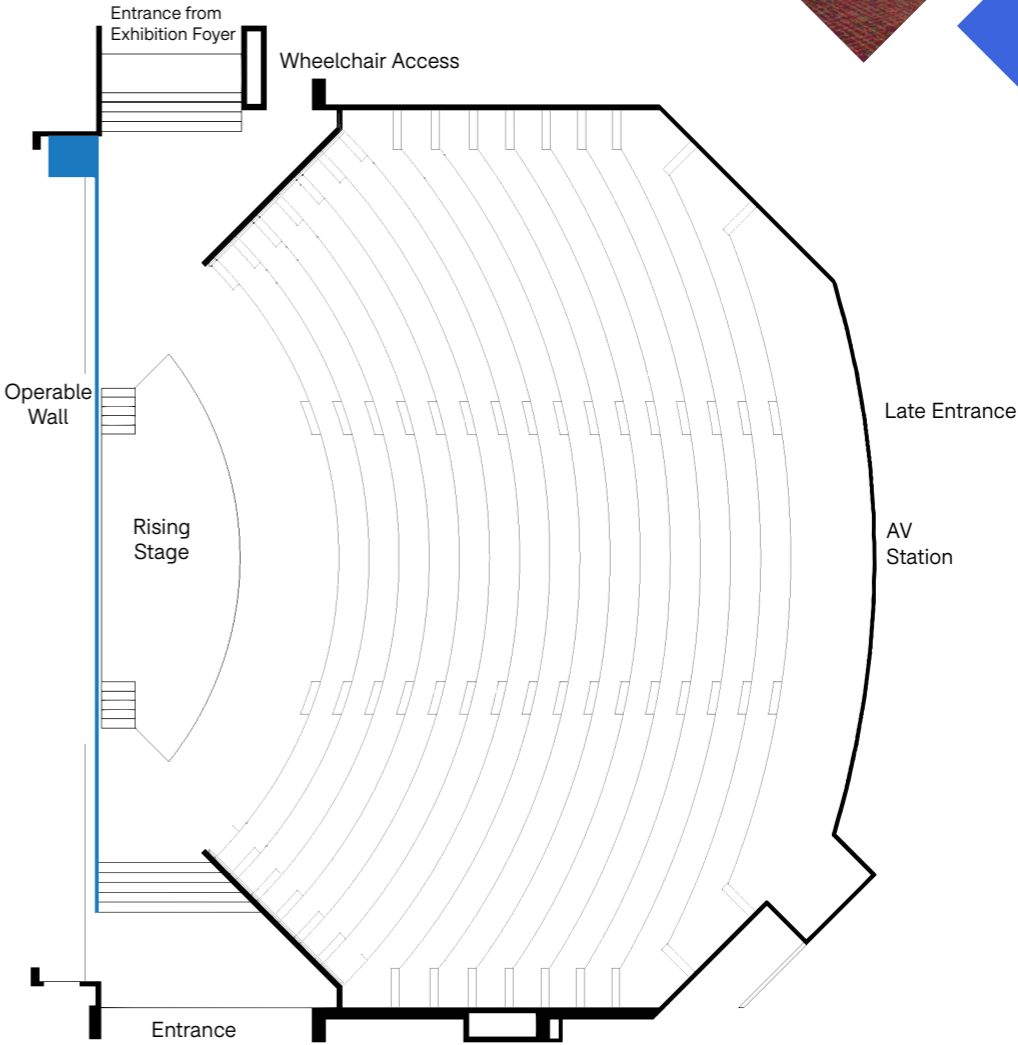
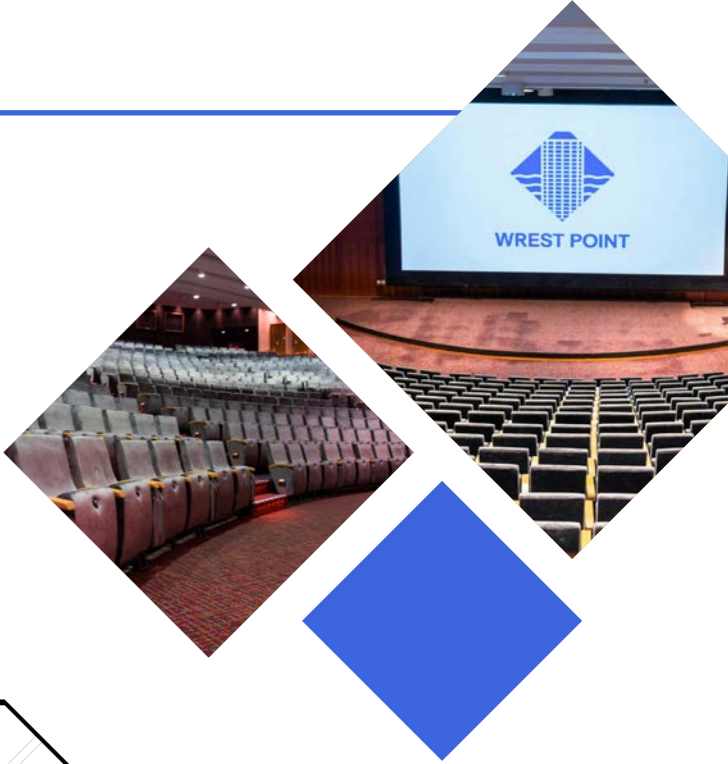

Room	Floor Area							
Plenary Hall	648m ²	651	70	100		600		4
Tasman & Plenary Hall		1651	610	688	1000	900	376	45



EXHIBITION FOYER + DECK

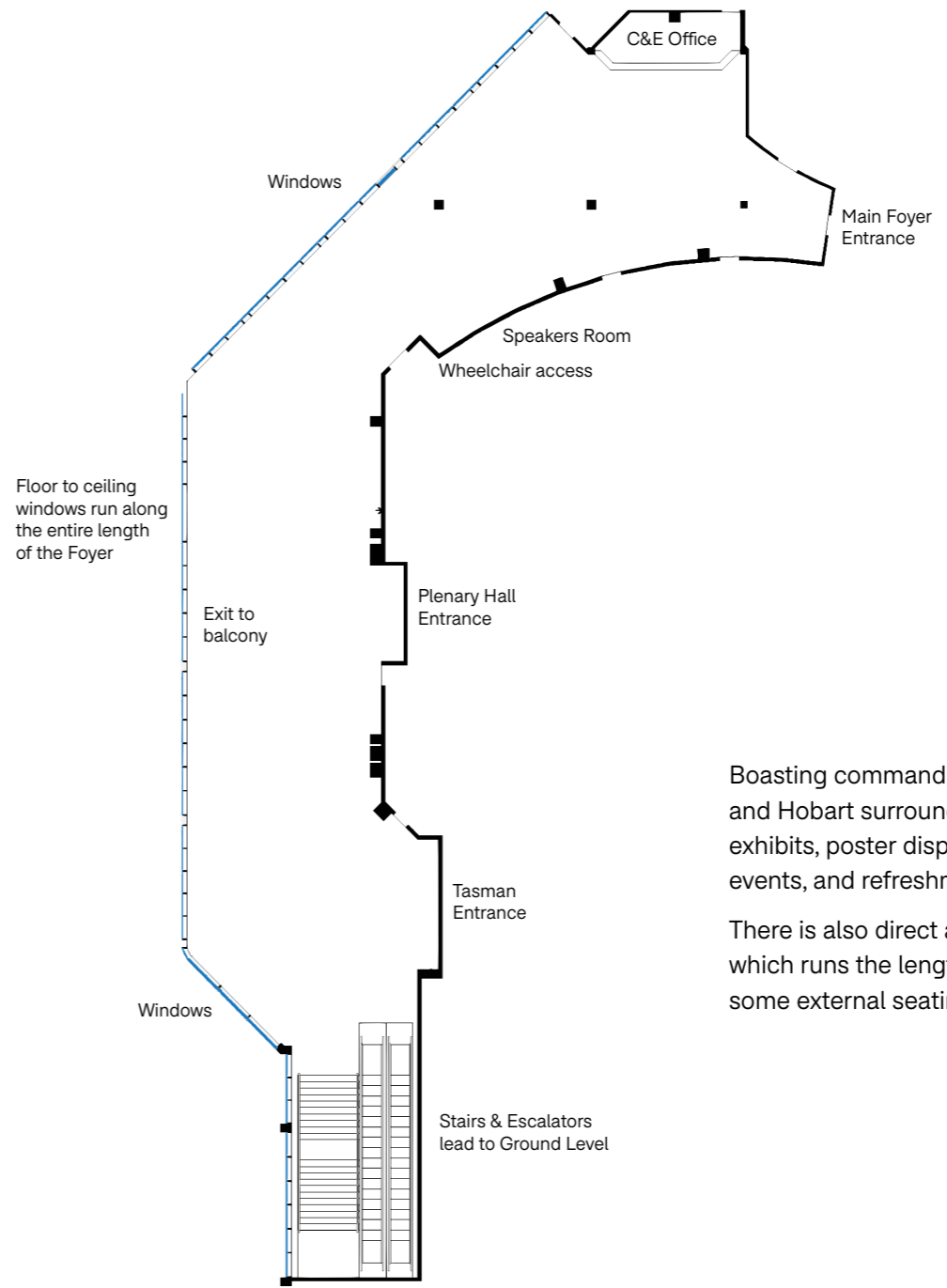

Boasting commanding views of the River Derwent and Hobart surrounds, this is the ideal space for trade exhibits, poster displays, cocktail receptions, special events, and refreshment breaks.

There is also direct access to the adjoining balcony which runs the length of the Conference Centre, where some external seating is available.

Room	Floor Area	Icon 1	Icon 2	Icon 3	Icon 4	Icon 5
Exhibition Foyer	620m ²	150	180	180	400	20



WELLINGTON ROOM

The Wellington Room is a multi-purpose venue well-suited to small and medium conferences, meetings, or workshops. With mountain and marina views, the room attracts plenty of natural light.

This space can be used with the adjacent foyer and Boardwalk Gallery for larger events.

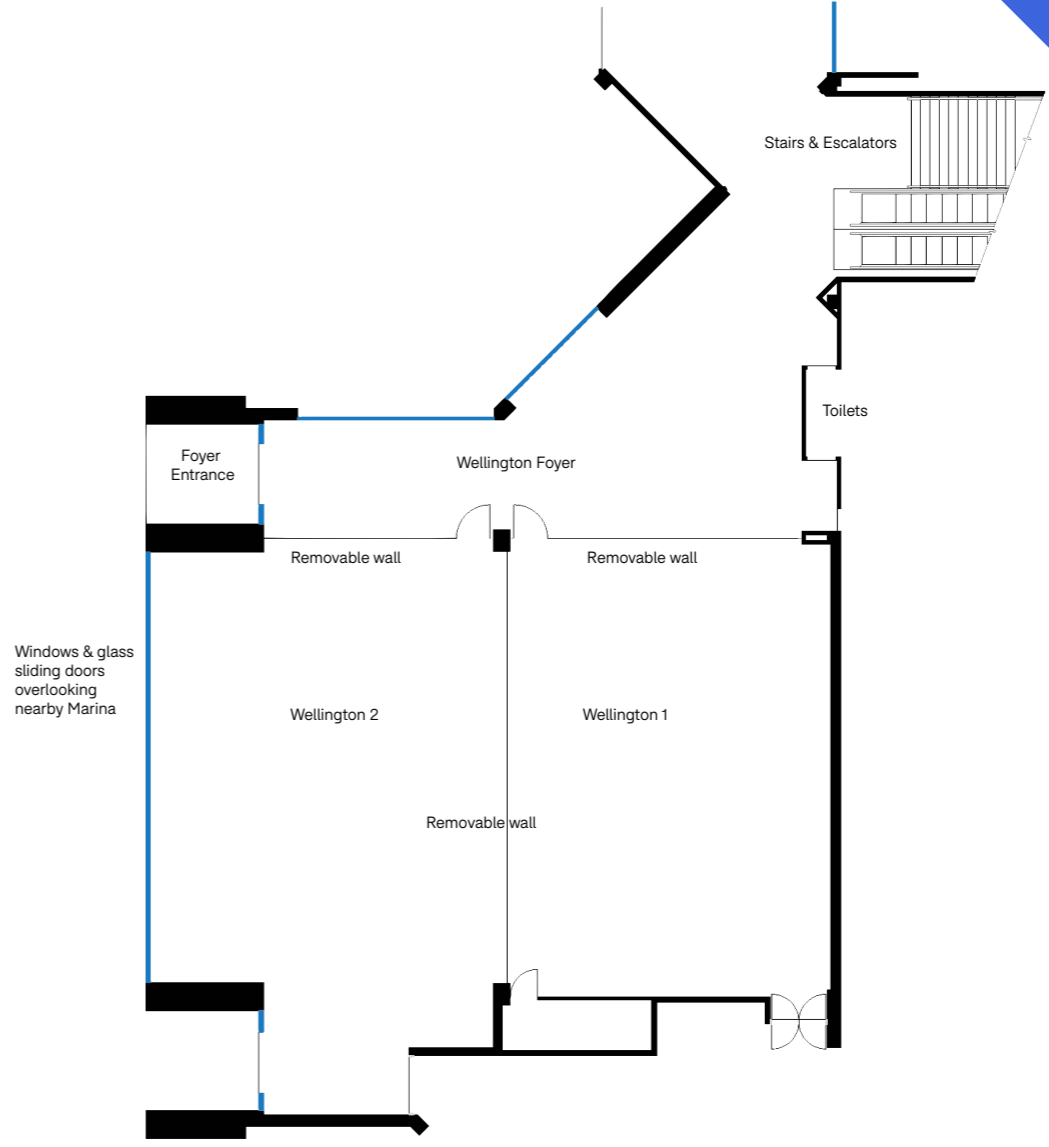

Room	Floor Area	Icon 1	Icon 2	Icon 3	Icon 4	Icon 5	Icon 6	Icon 7	Icon 8	Icon 9
Wellington	310m ²	200	150	180	200	40	100	40	120	17
Wellington 1	160m ²	100	50	90	100	30	50	30	40	
Wellington 2	150m ²	100	50	90	100	30	50	30	40	



BOARDWALK GALLERY

The view is the masterpiece in the Boardwalk Gallery, aptly named for its prime location on the waterfront. With floor-to-ceiling windows it is both scenic and intimate, providing the ideal location for cocktail receptions, trade exhibits, product launches, weddings, and training sessions.

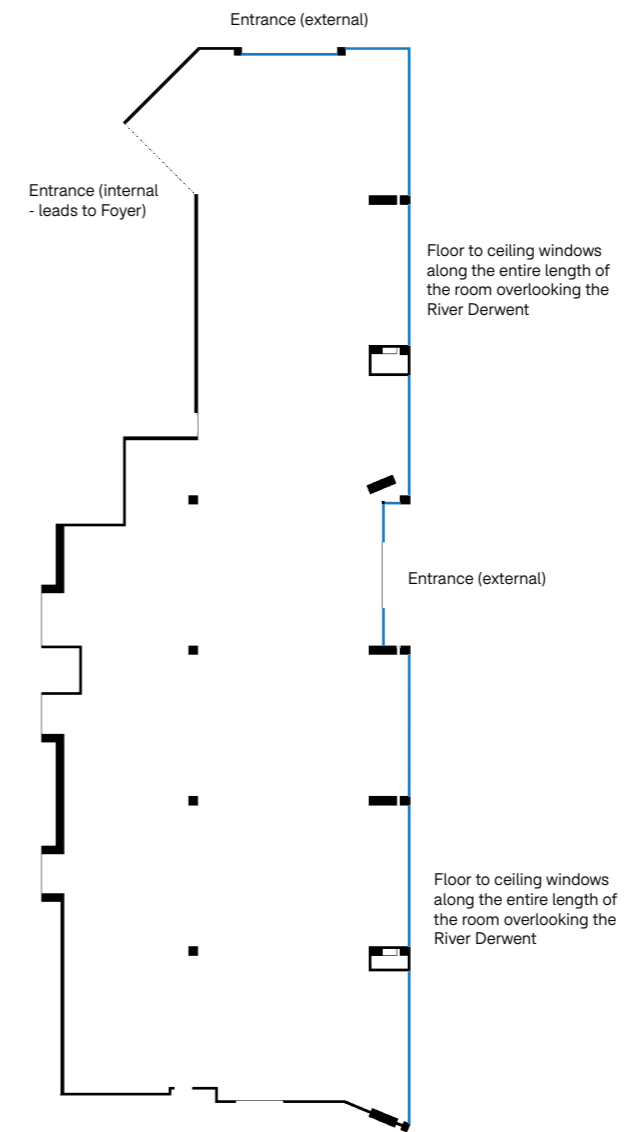

Room	Floor Area									
Boardwalk Gallery	520m ²	170	200	250	260	40	70	40	136	32



DRYSDALE ROOM

Designed as a waiting room for performers, the Drysdale Room can also be used for small meetings, workshops and cocktail receptions. Located on the top level of the Conference Centre, it has its own private facilities and access to the rear of the Tasman Room stage.

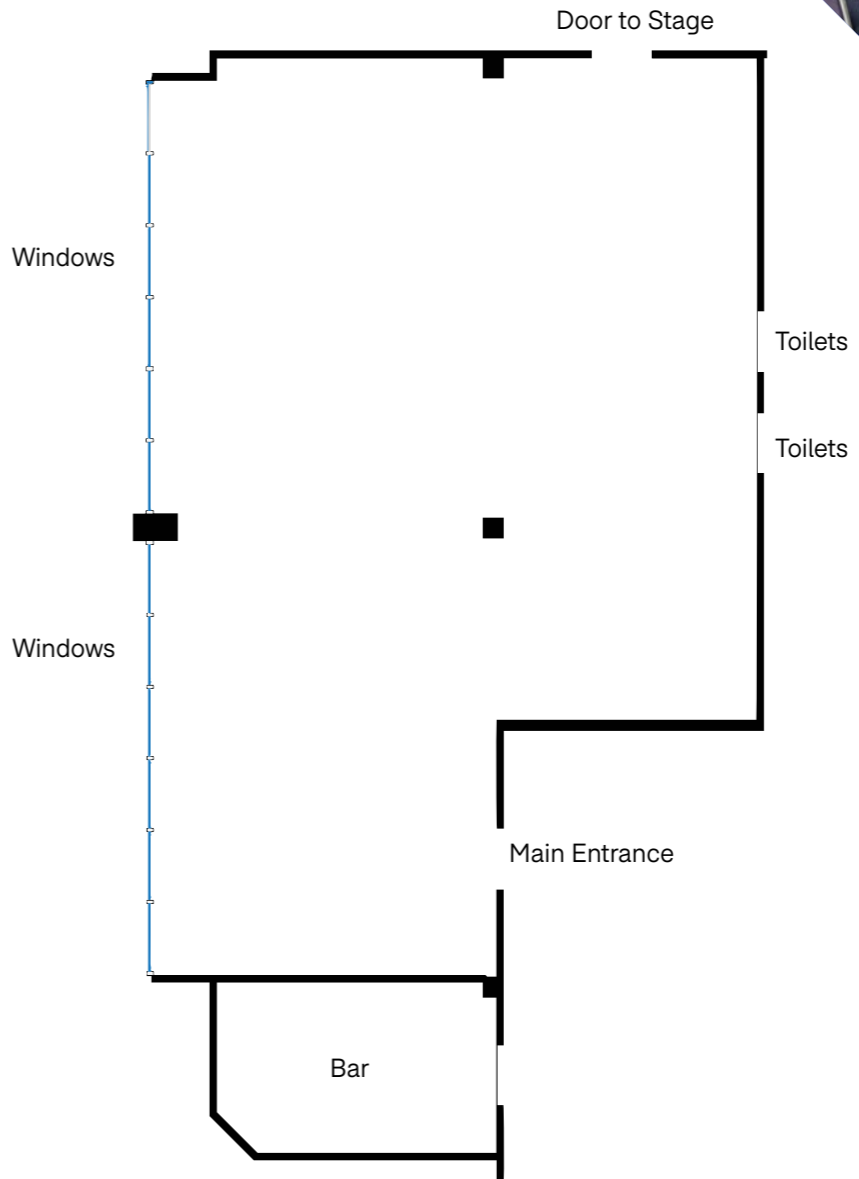

Room	Floor Area								
Drysdale Room	70m ²	50	50	50	50	20	35	25	40



DERWENT ROOM

The Derwent Room's classic art deco styling provides an ideal backdrop for dinners, cocktail parties, conferences, and meetings. Located in the original Wrest Point building, The Derwent Room can be configured to suit many events and can be split in half for smaller functions.

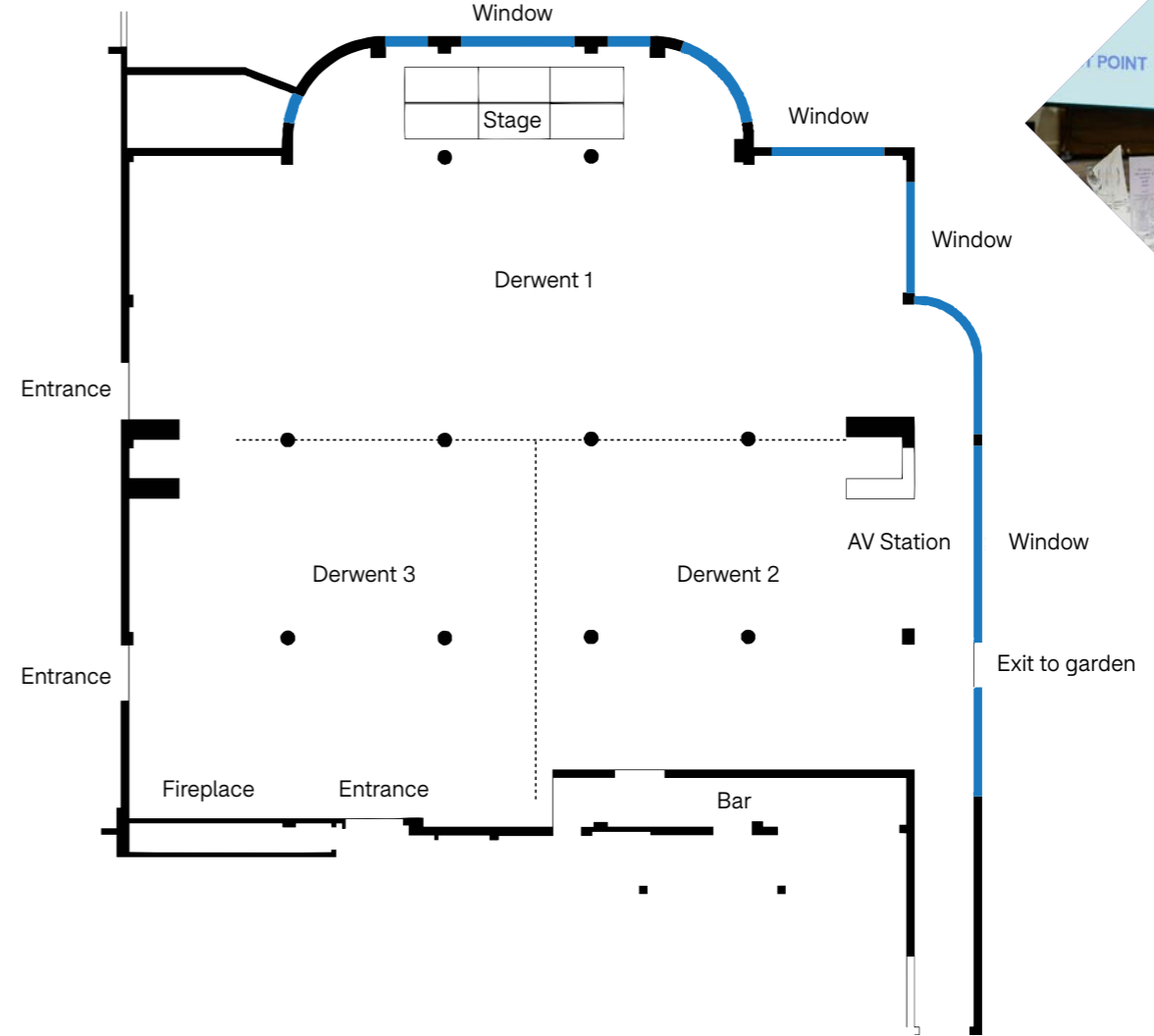

Room	Floor Area	Icon 1	Icon 2	Icon 3	Icon 4	Icon 5	Icon 6	Icon 7	Icon 8
Derwent	540m ²	280	240	300	300		120		160
Derwent 1	243m ²	170	110	140	150	40	75	35	88
Derwent 2	115m ²	40	30	40	50	20	20	25	24
Derwent 3	136m ²	50	40	50	75	20	25	25	24



THE SHOWROOM

The Showroom is made for those who flourish on centre stage. Entertainment royalty from far and wide has performed here. With tiered flooring and a purpose-built stage, the room easily transitions from rock concert stage to intimate theatre with a range of room configurations.

Originally designed for cabaret, comedians, musicians and keynote speakers will find themselves equally at home in The Showroom.

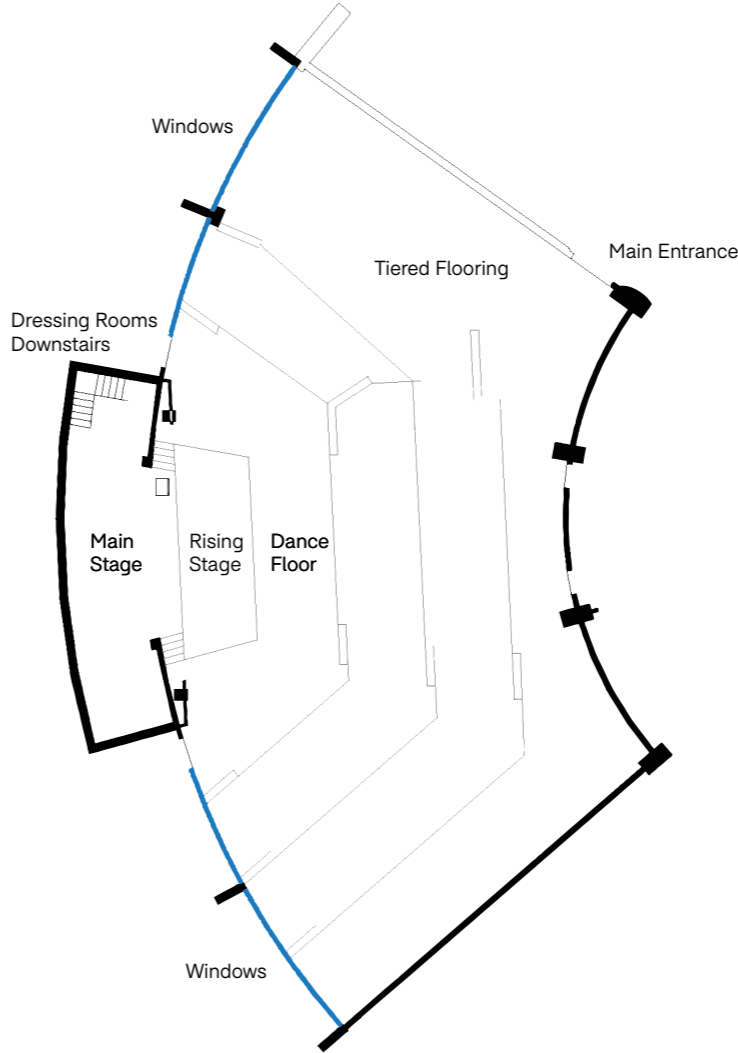

Room	Floor Area							
Showroom	447m ²	346	230	200	20	100	25	152



RIVIERA ROOM

Discover the Riviera Room, your ideal setting for elevated business engagements and intimate gatherings. Bathed in natural light, this inviting space is meticulously designed to serve as the perfect backdrop for high-impact business presentations, small-scale functions and relaxed receptions.



Room	Floor Area					
Riviera Room	60m ²	40	40	20	25	25

ACCOMMODATION

Your journey to exceptional experiences starts with the perfect stay. Wrest Point offers a range of accommodation options that cater to every preference and need. Whether you're seeking premium waterfront suites with breath-taking views, or a budget-friendly stay, we have it all.



Harbour Suite

\$\$\$

Spend a night in the iconic Wrest Point tower. Enjoy the breathtaking views of the River Derwent from the lounge area, or pamper yourself in the oversized bathroom with double vanities, luxury amenities, bath, and separate rain shower.

Tower Deluxe King

\$\$

Boasting spectacular views of the harbour, city and mountain these deluxe rooms are located on floors 5 to 16. Features walk in shower, luxury king bed, coffee pod machine, high speed Wi-Fi, and more.



Tower Deluxe Twin Room

\$\$

Located on 1st to 4th floors with magnificent views across the Derwent River, Hobart city and kunanyi / Mount Wellington. Features walk in shower, one queen and one single bed, coffee pod machine, high speed Wi-Fi, and more.



Water Edge Room

\$

Situated in the historic Riviera wing of Wrest Point are our cosy 4-star Water Edge rooms. Overlooking the shores of the River Derwent, this peaceful and picturesque location is the perfect place to rest in Hobart. Room options are king bed or double and single bed.



Motor Inn Room

\$

Located on the mountainside of Wrest Point, Motor Inn rooms provide comfort and great value. Features a queen and single bed, flat-screen television with Foxtel channels and in-house TV channels, and direct access to car parking.



RESTAURANTS

The Point Revolving Restaurant

Seventeen floors above the River Derwent, The Point Revolving Restaurant is the destination for your special occasions.

A fine dining experience with a French-inspired menu, here you'll enjoy an ever changing view from the top of Tasmania's tallest building.



Longhorn Smokehouse

For jaw dropping views, mouth watering meats and great hospitality, dine at Longhorn Smokehouse. Here you'll sink your teeth into the best grilled and smoked meats, from pork ribs to succulent Cape Grim Brisket, sourced from the finest local producers.



Boardwalk Bistro & Café

Dishing up great quality food, Boardwalk Bistro is a family-friendly destination with a focus on great value. With a boardwalk deck extending over the River Derwent, this restaurant is a crowd favourite with classic pub feeds, carvery, and more.



Kwan Ho

Kwan Ho specialises in a range of Cantonese, Sichuan, Shanghai, and other Chinese cuisines and encourages traditional shared banquets to enjoy with friends and family.

This premium dining venue overlooks the River Derwent, Tasman Bridge, and the neighbouring marina.

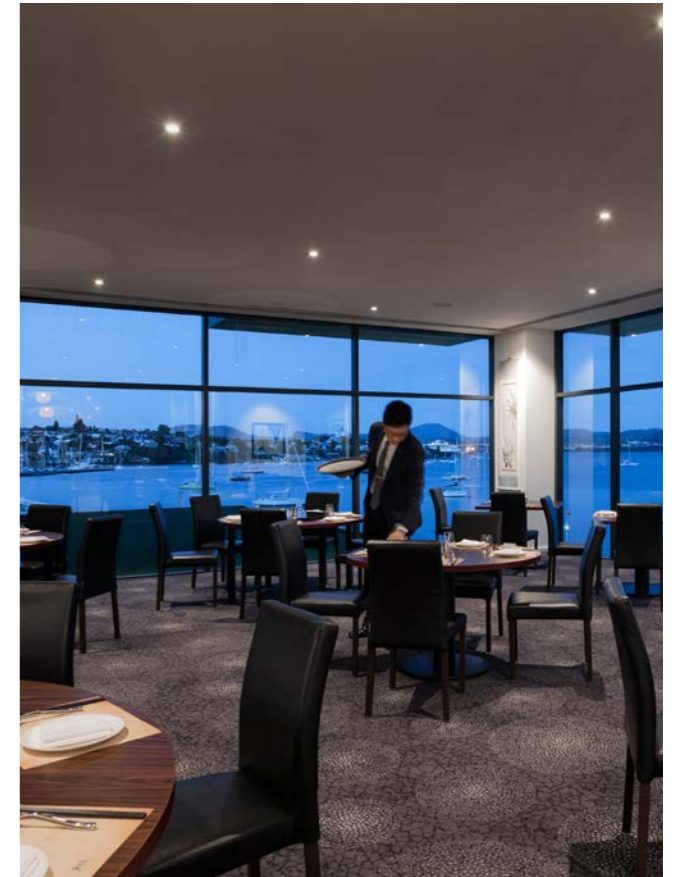

BARS

Birdcage Bar

Wrest Point's iconic bar since 1973, Birdcage is the home of signature cocktails, cocktail high tea, and live entertainment.



The Green Room Bar

The Green Room Bar is all about classic cocktails and good times. The perfect place for post-event drinks, enjoy live music and a great range of old-school cocktails and bar snacks.



Casino Bar

Soak up the theatre of Hobart's boutique casino while you enjoy your drink of choice at Casino Bar. Overlooking the River Derwent, this bar offers panoramic views across the Wrest Point lawns to the Tasman Bridge.



Boardwalk Bar

Located on the water at Wrest Point, Boardwalk Bar dishes up a great range of drinks, casual meals, and bar snacks. Catch all the live sports action on the big screens or just enjoy the views and a cold drink.



Our Community



Our Community

Variety Tasmania and Variety TasBash

Wrest Point has been a passionate supporter of *Variety: The Children's Charity* in Tasmania since 1993. We do this by helping them to deliver programs and grants to sick or disadvantaged children and holding events like the 'Variety of Gins,' and the annual 'Variety of Chefs' gala dinner, led by Executive Chef Andre Kropp.

Beacon Foundation

As Tasmania's leading Hospitality employer, we are proud to partner with the *Beacon Foundation* to help deliver work readiness programs to Tasmanian students. Our team members have visited schools across the state to share their career stories and inspire the next generation.



Our People

We continuously invest in our people.

Our highly skilled chefs are the heart and soul of our culinary prowess. With a relentless passion for their craft, our chefs continually hone their skills through training and competitions, such as the Variety of Chefs event.

Our talented baristas and bartenders are the lifeblood of our beverage excellence. With an unwavering commitment to their craft, our baristas and bartenders also consistently refine their abilities through training and competitive events.



Our Chefs



André Kropp

Executive Chef

André's 30-year career has spanned the globe, exposing him to much of the world's produce but it was Tasmania that he fell in love with and decided to call

home. "Here in Tasmania the freshest and best produce is never far from the plate."

André oversees more than 70 chefs across the Wrest Point property, he is the current Vice President of the Australian Culinary Federation (an Industry Organisation representing professional chefs, cooks, apprentices and culinary students) and regularly participates in international cooking competitions, including the Culinary Olympics and World Cup.

André was a member of the Australian National Culinary Team, winning gold and silver medals at the 2008 and 2012 Culinary Olympics in Germany, as well as the Singapore Culinary Challenge. He was fortunate to also be selected to represent Australia at the international final of the MLA Black Box Culinary Challenge, where his team placed third in the world. André is so respected he was invited to cook for 300 VIP guests at Savour China in Shanghai.

Passionate about our island state, Andre believes in showcasing the very best and freshest Tasmanian produce whenever possible and tells fellow chefs he is lucky to be able to work with some of the best produce in the world.



Robin Kelly

Senior Chef de Cuisine

Robin started his career at Wrest Point in 1992 as an apprentice chef, the foundation for a stellar career which has taken him around the world, and back to where it all began.

Robin has worked within 5-star hotels in Australia and the UK, including as Chef de Partie at Balmoral Hotel in Edinburgh, Scotland, and as Senior Chef de Partie at a Michelin-starred restaurant in London, and worked in all parts of the kitchen with talented chefs, where he developed a passion for patisserie and chocolate.

Over the last 20 years Robin has been a vital contributor to each kitchen team at Wrest Point and oversees the preparation of meals for functions and events (catering to groups of 20 to 1600 people), production and the pastry kitchens.

Robin is a valued member of the Tasmanian branch of the Australia Culinary Federation, where he regularly competes in National Chef competitions. In August 2015, Robin was awarded Tasmanian Chef of the Year, and travelled to Shanghai to cook for 300 VIPs at the Savour Tasmania event.

Working with Tasmania's first-class produce every day is Robin's favourite part of the job.

"It's great to know where the produce has come from, what environment it was grown or farmed in and to know that the environment is so unspoilt."



Paul Keenan

Senior Sous Chef

Paul's remarkable journey began in the heart of hospitality, as a Kitchen Hand at Wrest Point in 1993. This role marked the inception of his global career, and his

dedication and determination quickly propelled him forward.

In 1994, Paul was offered a Cookery apprenticeship, and over four years showcased his skills in various culinary competitions, earning silver and gold medals in The Hobart Salon Culinare.

In 2005 Paul ventured to the UK and worked as Senior Chef de Partie at Warren House in Surrey, under the mentorship of Paul Bellingham. Upon returning to Australia in 2007, Paul assumed the role of Junior Sous Chef at Kingfisher Eco Resort Fraser Island, managing Seabel Restaurant. In 2009, Paul rejoined Wrest Point as a Demi Chef, working under Kent Sullivan in The Point Revolving Restaurant.

Paul then moved to Flinders Island in 2011 and worked as Head Chef at the Furneaux Tavern. This was followed by a relocation to Melbourne in 2012 to work as a Sous Chef, and quickly assumed the role of Head Chef at Crowded House in Williamstown.

Paul returned to Wrest Point in 2017 and has since showcased his culinary expertise and excelled in various outlets. He was assigned the role of Senior Sous Chef in Events in 2023 which he thoroughly enjoys.

"I have always had a common interest in the hospitality industry with the goal of becoming a chef from an early age."

Our Suppliers

We are proud to source our goods from local suppliers and businesses who produce exceptional food and wine. Supporting local also helps us reduce our carbon footprint from unnecessary transportation. At Wrest Point, we take you on a culinary journey of the State's regions, leaving you with a true taste of Tasmania.

- A** Ashmore, Sustainably sourced, the best fish and seafood Tasmania has to offer.
- B** Cape Grim Beef is located in the far northwest corner of Tasmania. Shaped by wild Southern Ocean swells and with an abundant rainfall, Cape Grim has the cleanest air in the world. Cape Grim has a commitment to sustainable farming and ethical practices.
- C** Wild Clover Lamb from Clover Country is located at the foothills of the Dial Range of the north west coast of Tasmania.
- D** Huon Aquaculture, Australia's signature producer of Atlantic salmon, is a local family-owned company located in the south of Tasmania.
- E** Scottsdale Pork is a family owned business located in Tasmania's north east. At Scottsdale Pork, every effort is made to ensure the pigs are comfortable, happy and content.

- F** Petuna, family-owned and award-winning company, committed to produce the highest quality and sustainably sourced seafood whilst responsibly maintaining the welfare of fish and the environment.
- G** Nichols Poultry comes from the green pastures of Sassafras, located in the north of Tasmania.
- H** Freycinet Marine Farm, situated on the pristine shores of Coles Bay in Tasmania, is a renowned purveyor of fresh and sustainably farmed seafood.
- I** Devil's Corner Winery, nestled amidst the pristine beauty of Apslawn, the winery harnesses the unique terrain of the region, with its cool maritime climate and fertile soil, to craft exquisite, award-winning wines.
- J** Ninth Island (Kreglinger Wine Estates), a prominent Tasmanian winemaker known for crafting elegant, sustainable practices and premium wines, especially celebrated for their exceptional Pinot Noir, Chardonnay, and sparkling varieties.
- K** Holm Oak, nestled in the idyllic Tamar Valley of Tasmania, is a boutique winery that has made a big name in the world of cool-climate wines. Their dedication to sustainable viticulture and a commitment to producing exceptional, site-specific wines has earned them a reputation as a Tasmanian gem in the world of fine wine.



We also proudly support

- Ziggy's Smallgoods
- Tasmanian Octopus Products
- Ashgrove Dairy
- Elemi Labna
- Pyengana Dairy Company
- Westhaven Dairy
- Lenah Game Meat

CONTACT US

📍 410 Sandy Bay Road Sandy Bay TAS 7005

☎ +61 3 6221 1712

sales@wrestpoint.com.au

www.wrestpoint.com.au



WREST POINT
Come Play.