



THE GRACE
SYDNEY

OUR *story*

The landmark Grace Building was originally built by the Grace Bros. retail empire in the late 1920s as a showpiece of their success. Beautifully restored to its former glory, The Grace Hotel is one of Sydney's prominent examples of Neo-Gothic architecture and Art-Deco interiors.

Located in the heart of Sydney CBD, the heritage-listed Grace Hotel offers warm and personal service with the luxury of a 4.5-star hotel. The hotel exudes a unique blend of old-world charm and modern comfort.

PROPERTY FEATURES

- 387 accommodation rooms
- 11 function rooms
- Room service
- Fitness centre
- Retail

The function rooms offer a range of flexibility for any type of event. Each room is as charming as the next and allows for an abundance of natural light. They are perfect for various sizes of meetings, conferences, seminars and private dining arrangements.

Welcome to The Grace Hotel, where old-world charm uniquely blends with modern comfort.

Location

The Grace Hotel is conveniently located in the heart of Sydney's Central Business District (CBD).

Find Sydney's bustling hub at your doorstep as the hotel is only minutes away from the best shopping, dining, arts, and entertainment.

EVENTS WITH BENEFITS

Get in contact with our professional Conference & Events Team and experience what makes us stand out.

For more information:

☎ 02 9272 6619

✉ conference@gracehotel.com.au,

🌐 gracehotel.com.au/meetings-events





Accommodation

The hotel comprises of 387 beautifully refurbished guest rooms located across 11 floors of the heritage-listed building.

Located in the heart of Sydney CBD, our rooms will surprise and delight you.

CAR PARKING

Plaza Parking is operated by a third party and is subject to their conditions.

Plaza Parking is located beneath the hotel with its entrance on 124 Clarence Street. There are limited car spaces and they are available on a first-in basis.



Function rooms

KING

Sophisticated and versatile, this room is well suited to meetings, training, small-scale networking evenings, and similar events.

BALINGA

A great room for a cosy yet professional atmosphere for a meeting, workshop, dinner or seminar.

PINAROO 4

Ideal for meetings, capable of hosting up to 45 guests (seated).

PINAROO 5

Great for presentations, seminars, conferences, hosting up to 65 guests (seated).

PINAROO 4-5

Combination of Pinaroo 4 & 5
Perfect for large-scale presentations, seminars, conferences, and events.

WILARRA

Comfortable for medium-sized meetings, as well as networking events, or seminars, hosting up to 60 banquet-style.

YURRA

Offers charming ambience and natural light, ideal for meetings, conferences and seminars.

MARRA

Suited to a variety of different functions, hosting up to 55 seated.

KIRRALAA

Ideal for presentations, training, small-scale conferences and dinner events.

JARARA

Ideal for a small board meeting, a small breakout room

ILUKA

Suitable for small meetings, can accommodate up to 16 guests, cabaret-style.

JARARA - ILUKA

Combination of Jarara & Iluka
Offers charming ambience and natural light, ideal for meetings, conferences and seminars.

WILARRA - KIRALAA

Combination of Wilarra, Yurra, Marra & Kiralaa
It can be either one large conference space or divided up into separate conferences or breakout rooms. Ideal for conferences, private dinners or cocktail events.

WILARRA - JARARA

Combination of Wilarra, Yurra, Marra, Kiralaa & Jarara
One of the largest spaces in the hotel. Ideal for large-scale conferences, networking events and seminars.

ALKIRA TERRACE

Offers a charming ambience and views of the city skyline.
Ideal for cocktail events, exclusive dining arrangements and company parties.

PRE-FUNCTION AREA

Perfect for pre-registration, trade stands, product displays, organiser tables, breakout areas, casual meetings, and pre/post event drinks.

CONFERENCE & EVENT FACILITIES

- Caters up to 400 guests
- Full catering with dietary requirements
- Extensive F&B menus
- Wireless broadband internet
- Wheelchair accessible[^]
- Audio-visual facilities with an on-site technician^{**}
- Teleconferencing^{**}

^{*}Room hire charges may apply to all conferences, meetings and events.

^{**}Prices quoted separately.

[^]Available for all functions rooms except Alkira Terrace, located on Level 12.



ABOVE ARE ARTIST IMPRESSIONS. DESIGNS ARE INDICATIVE AND SUBJECT TO CHANGE

Room dimensions & capacities

LEVEL 1

	Meters	m2	Ceiling Height	Boardroom	U-shape	Classroom	Theatre	Cabaret	Banquet	Reception
King	6.5 x 9.0	58.5	2.75	21	21	27	45	24	30	40
Balinga	7.0 x 15.0	105	3	39	42	75	105	56	80	120
Pinaroo 4	10.0 x 7.3	73	2.85	21	24	27	45	32	40	60
Pinaroo 5	12.7 x 6.0	76	2.85	30	30	33	65	40	50	70
Pinaroo 4-5	13.5 x 12.7	149	2.85	-	-	60	110	72	90	130

LEVEL 2

	Meters	m2	Ceiling Height	Boardroom	U-shape	Classroom	Theatre	Cabaret	Banquet	Reception
Wilarra	16.5 x 6.5	105	2.4	33	33	42	100	48	60	120
Yurra	12.5 x 6.5	80	2.4	27	30	30	55	40	50	100
Marra	12.5 x 6.0	75	2.4	27	30	30	55	32	40	90
Kirralaa	11.5 x 6.1	72	2.4	21	21	27	45	32	40	70
Jarara	6.5 x 6.0	39	2.4	12	12	12	24	16	20	20
Iluka	6.5 x 8.0	54	2.4	12	12	12	25	16	20	30
Wilarra-Jarara	32 x 16.5	371	2.4	-	-	141	279	192	240	400
Wilarra-Kirralaa	-	332	2.4	-	-	129	255	176	220	380
Wilarra-Marra	-	260	2.4	-	-	102	210	120	150	320
Wilarra-Yurra	-	185	2.4	-	-	72	155	88	110	230
Yurra-Jarara	-	265	2.4	-	-	99	179	120	150	280
Yurra-Kirralaa	19.3 x 6.5	227	2.4	-	-	87	155	104	130	260
Yurra-Marra	13.0 x 6.5	155	2.4	-	-	60	110	72	90	190
Marra-Kirralaa	12.3 x 6.0	147	2.4	-	-	57	100	64	80	160
Jarara-Iluka	14.5 x 6.5	40	2.4	-	27	27	50	32	40	50

LEVEL 12

	Meters	m2	Ceiling Height	Boardroom	U-shape	Classroom	Theatre	Cabaret	Banquet	Reception
Alkira	12.0 x 9.0	87.8	2.4	21	21	24	40	24	30	70

Floor plan

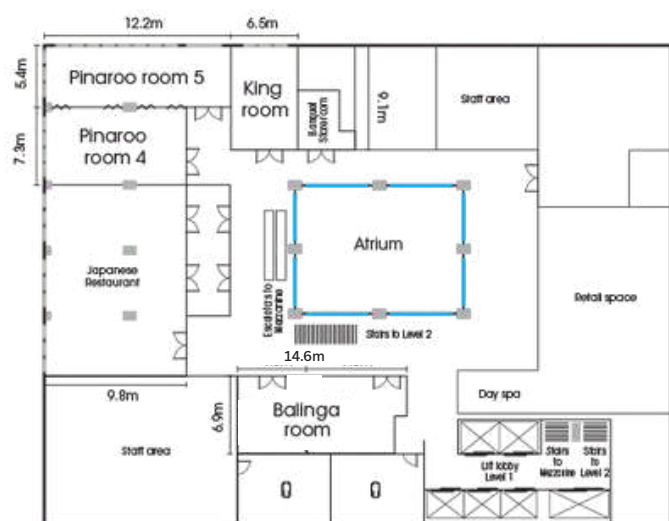

LEVEL 1

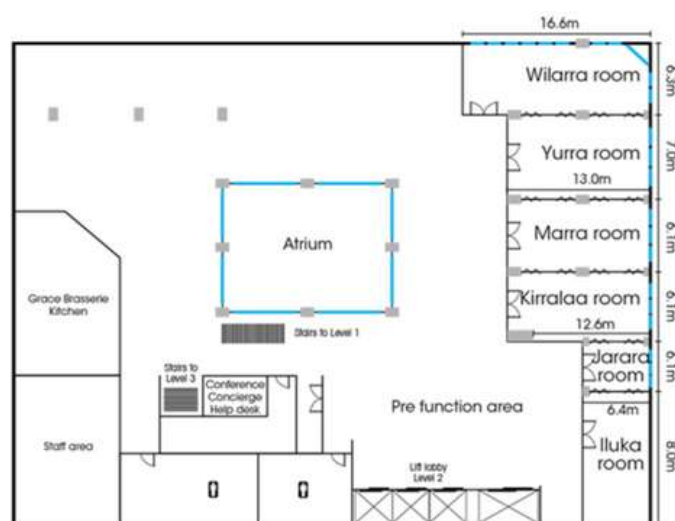

LEVEL 2



LEVEL 12

Inclusions

- Arrival tea and coffee
- Morning tea with daily selection
- Conference lunch
- Non-alcoholic refreshments with lunch
- Afternoon tea with daily selection
- Whiteboard and flipchart
- Pens, notepads, mints and water
- Complimentary standard WiFi

HALF-DAY CONFERENCE PACKAGE IS ALSO AVAILABLE.

Please contact the conference and events team on conference@gracehotel.com.au or 02 9272 6619.



DAY DELEGATE *package*



THE GRACE HOTEL SYDNEY

📍 77 York Street, Sydney 2000

☎ **C&E Team:** 02 9272 6619

✉ **C&E Team:** conference@gracehotel.com.au

🌐 gracehotel.com.au